

AE

ELITE TRAILERS

EXPERIENCE THE ELITE DIFFERENCE



THE MUSTANG

3 & 4 HORSE GOOSENECK
2, 3 & 4 HORSE GOOSENECK LQ





MUSTANG

3 & 4 HORSE GOOSENECK

EXTERIOR FEATURES

- 2-5/16" Adjustable Coupler with Safety Chains and Breakaway Kit
- Single Speed Landing Gear
- 7'6" Long Nose with 2' Taper and Stainless Front Nose Sheet
- Extruded Side Slats with Smooth White or Black Sheets Above
- (2) 5200#/102" Axles with Electric Brakes
- (5) LT235/85R16 Radials with 16" Modular Wheels and Caps
- Spare Tire Carrier
- 7 Way Plug and Wiring Harness
- Drop Down Feed Doors with Windows and Drop Bars on Streetside
- Escape Door at 1st Stall on Streetside
- 15' x 34" Windows with Bars on Curbside
- Double Rear Doors with 15" x 24" Windows
- (4) Exterior Tie Rings, Two Each Side
- LED Exterior Clearance Lights
- Halogen Load at Rear
- Rubber Dock Bumper

HORSE AREA FEATURES

- Popup Two-way Roof Vent, One per Stall
- Side Walls are Insulated and Lined with .100 Aluminum and Rubber 54" High on Rump Wall and 48" High on Head Wall
- Removable Dividers with Padding on Each Side
- Collapsible Rear Tack with Removable Center Post
- Saddle Rack and LED Dome Light in Rear Tack
- (1) Padded Butt Bar and (1) Padded Breast Bar
- (2) Inside Tie Rings per Horse
- (5) Bridle Hooks
- (2) LED Dome Lights in Horse Area with Switch Recessed on Rear Post

DRESSING ROOM FEATURES

- 15" x 34" Window on Each Side of the Gooseneck
- Door with 15" x 24" Window, Camper Latch & Dead Bolt - Street Side

Door with 15" x 27" Window, Camper Latch & Dead Bolt - Street Side
Extra Saddle Rack Location and LED Dome Light
Marine Grade Carpeted Gooseneck Bed, Drop Wall and Floor
Accessories include (5) Bridle Hooks and (1) Blanket Bar on Bulk Head Wall, 4' Clothes Rod and (1) LED Dome Light with Switch Inside Dress Door and (1) Brush Tray on Dress Door

OPTIONAL FEATURES

- Drop Down Doors on Curbside
- Removable Divider Panel
- 48" Tall Ramp Behind Rear Doors
- Hay Rack
- Aluminum Wheels

Photos may contain Optional Features

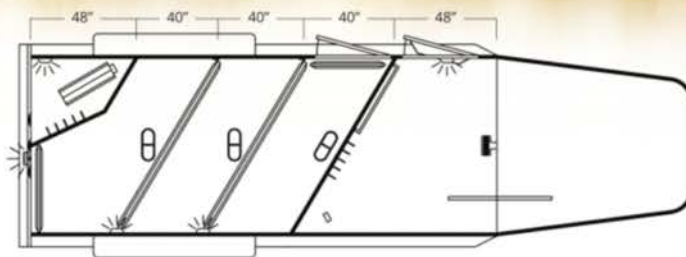

3 HORSE MUSTANG
7' W x 18' L (Floor) x 7' H

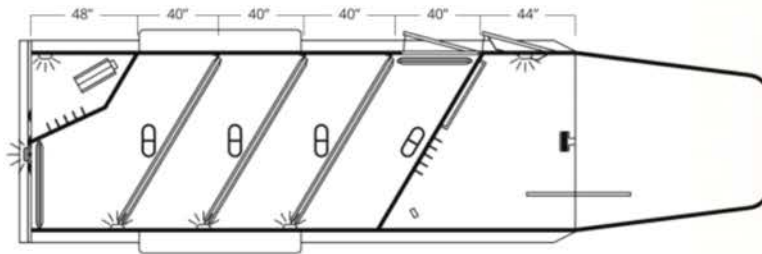

4 HORSE MUSTANG
7' W x 21' L (Floor) x 7' H





MUSTANG LQ

2 HORSE GOOSENECK

8'8" OR 10'8" LIVING QUARTERS SHELL

EXTERIOR FEATURES

2-5/16" Coupler with Safety Chains and Breakaway Kit

7K Equalizer Hydraulic Jacks

8' Long Nose with 2' Taper and Stainless Front Nose Sheets

Extruded Side Slats with Smooth White or Black Sheets Above

(2) 7,000# Rubber Torsion Axles with Electric Brake

(5) LT235/85R16 Load Range "E" Radials with 16" Stainless Simulators

7 Way Plug and Wiring Harness

Drop Down Doors with Windows at SS and CS with Lower Latch

Mustang Drop Down Window Bars on Streetside

Escape Door with Drop Down Door with Windows at 1st Horse

Double Rear Doors with Pressure Latches (56/44)

(1) Kickout Window in Nose (Streetside)

19" x 34" Window in Nose (Curbside)

15" x 24" Sliding Kitchen Window

18" or 22" x 48" Sliding Window behind Sofa or Dinette

Elite Built LQ Door with Fold Up Step

44-1/2" Drop Wall Height

(4) Exterior Ties, 2 Each Side

(4) LED Dome Lights (1x Rear Tack, 2x Horse Area, 1x Mangers)

Spare Tire Carrier and Dual Battery Box with (2) Batteries

LED Load Light at Rear and LED Exterior Clearance Lights

Rubber Dock Bumper

HORSE AREA FEATURES

Marine Grade .125 Smooth Aluminum Floor

18" Deep Mangers with Exterior Access Doors

Padding on Bulkhead Wall and Rear Tack Wall

Bulkhead Wall with Walk Thru Door

Rubber Floor Mats

Horse Dividers with Padding

Smooth Rubber on Manger, Rump Wall and Bulkhead Wall

Double Wall and Insulated Side Walls

Two-way Roof Vent, One per Stall

Breast/Butt Bars at Doors

(2) Interior Ties per Horse

REAR TACK FEATURES

Collapsible Rear Tack Wall with Removable Center Post

(2) Carpeted Saddle Racks on a Removable Post

(10) Bridle Hooks

Brush Tray on Rear Tack Door

Blanket Bar

Photos may contain Optional Features

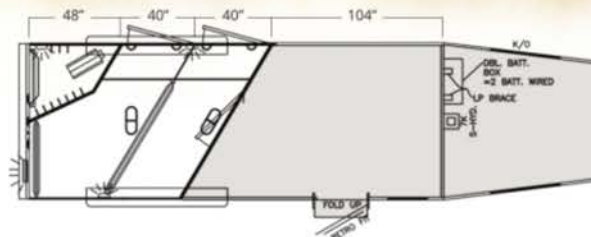

2 HORSE MUSTANG LQ - 8'8" LIVING QUARTERS

8' W x 19'4" L x 7'6" H

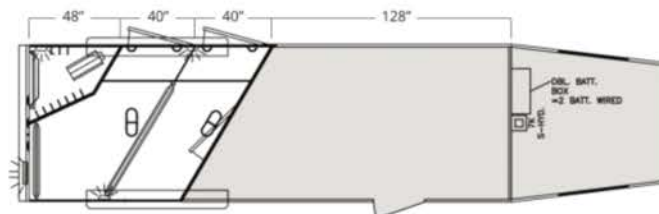

2 HORSE MUSTANG LQ - 10'8" LIVING QUARTERS

8' W x 21'4" L x 7'6" H



MUSTANG LQ

3 HORSE GOOSENECK
8'8" OR 10'8" LIVING QUARTERS SHELL

EXTERIOR FEATURES

2-5/16" Coupler with Safety Chains and Breakaway Kit

7K Equalizer Hydraulic Jacks

8' Long Nose with 2' Taper and Stainless Front Nose Sheets

Long Nose with 2 Paper and Stainless Front Nose Sheet
 Extruded Side Slats with Smooth White or Black Sheets Above
 (2) 7,000# Rubber Torsion Axles with Electric Brake
 (5) LT235/85R16 Load Range "E" Radials with 16" Stainless Simulators
 7 Way Plug and Wiring Harness
 Drop Down Doors with Windows at SS and CS with Lower Latch
 Mustang Drop Down Window Bars on Streetside
 Escape Door with Drop Down Door with Windows at 1st Horse
 Double Rear Doors with Pressure Latches (56/44)
 (1) Kickout Window in Nose (Streetside)
 19" x 34" Window in Nose (Curbside)
 15" x 24" Sliding Kitchen Window
 18" or 22" x 48" Sliding Window behind Sofa or Dinette
 Elite Built LQ Door with Fold Up Step
 44-1/2" Drop Wall Height
 (4) Exterior Ties, 2 Each Side
 (4) LED Dome Lights (1x Rear Tack, 2x Horse Area, 1x Mangers)
 Spare Tire Carrier and Dual Battery Box with (2) Batteries
 LED Load Light at Rear and LED Exterior Clearance Lights
 Rubber Dock Bumper

HORSE AREA FEATURES

Marine Grade .125 Smooth Aluminum Floor
 18" Deep Mangers with Exterior Access Doors
 Padding on Bulkhead Wall and Rear Tack Wall
 Bulkhead Wall with Walk Thru Door
 Rubber Floor Mats
 Horse Dividers with Padding
 Smooth Rubber on Manger, Rump Wall and Bulkhead Wall
 Double Wall and Insulated Side Walls
 Two-way Roof Vent, One per Stall
 Breast/Butt Bars at Doors
 (2) Interior Ties per Horse

REAR TACK FEATURES

Collapsible Rear Tack Wall with Removable Center Post
 (3) Carpeted Saddle Racks on a Removable Post
 (10) Bridle Hooks
 Brush Tray on Rear Tack Door
 Blanket Bar

Photos may contain Optional Features

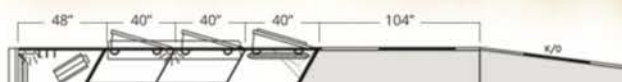

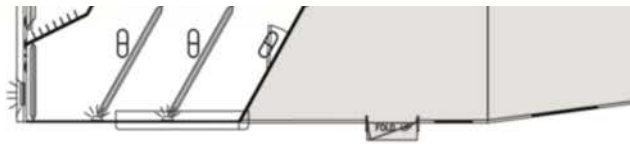

3 HORSE MUSTANG LQ - 8'8" LIVING QUARTERS
8' W x 22'8" L x 7'6" H

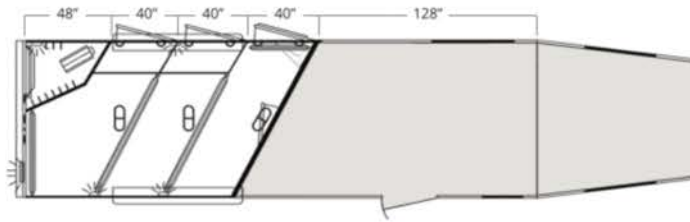

3 HORSE MUSTANG LQ - 10'8" LIVING QUARTERS
8' W x 24'8" L x 7'6" H





MUSTANG LQ

4 HORSE GOOSENECK

8'8" OR 10'8" LIVING QUARTERS SHELL

EXTERIOR FEATURES

- 2-5/16" Coupler with Safety Chains and Breakaway Kit
- 7K Equalizer Hydraulic Jacks
- 8' Long Nose with 2' Taper and Stainless Front Nose Sheets
- Extruded Side Slats with Smooth White or Black Sheets Above
- (2) 7,000# Rubber Torsion Axles with Electric Brakes
- (5) LT235/85R16 Load Range "G" Radials with 16" Stainless Simulators
- 7 Way Plug and Wiring Harness
- Drop Down Doors with Windows at SS and CS with Latch
- Mustang Drop Down Window Bars on Streetside
- Escape Door with Drop Down Door with Windows at 1st Horse
- Double Rear Doors with Pressure Latches (56/44)
- (1) Kickout Window in Nose (Streetside)
- 19" x 34" Window in Nose (Curbside)
- 15" x 24" Sliding Kitchen Window
- 18" or 22" x 48" Sliding Window behind Sofa or Dinette
- Elite Built LQ Door with Fold Up Step
- 44-1/2" Drop Wall Height
- (4) Exterior Ties, 2 Each Side
- (4) LED Dome Lights (1x Rear Tack, 2x Horse Area, 1x Mangers)
- Spare Tire Carrier and Dual Battery Box with (2) Batteries
- LED Load Light at Rear and LED Exterior Clearance Lights
- Rubber Dock Bumper

HORSE AREA FEATURES

- Marine Grade .125 Smooth Aluminum Floor
- 18" Deep Mangers with Exterior Access Doors
- Padding on Bulkhead Wall and Rear Tack Wall
- Bulkhead Wall with Walk Thru Door
- Rubber Floor Mats
- Horse Dividers with Padding
- Smooth Rubber on Manger, Rump Wall and Bulkhead Wall
- Double Wall and Insulated Side Walls
- Two-way Roof Vent, One per Stall

Breast/Butt Bars at Doors

(2) Interior Ties per Horse

REAR TACK FEATURES

Collapsible Rear Tack Wall with Removable Center Post

(4) Carpeted Saddle Racks on a Removable Post

(10) Bridle Hooks

Brush Tray on Rear Tack Door

Blanket Bar

Photos may contain Optional Features

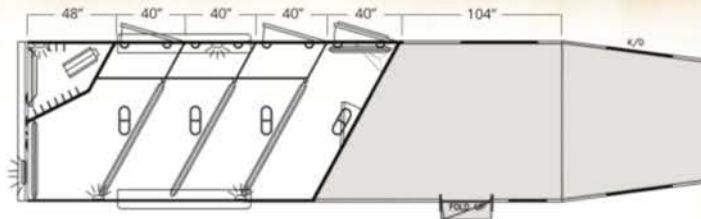

4 HORSE MUSTANG LQ - 8'8" LIVING QUARTERS

8' W x 26' L x 7'6" H

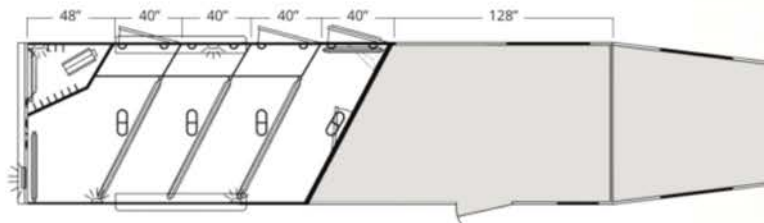

4 HORSE MUSTANG LQ - 10'8" LIVING QUARTERS

8' W x 28' L x 7'6" H





MUSTANG LQ SHELL

POPULAR OPTIONS

The following options are available to the Mustang LQ Shell.

Swing Out Blanket Bars for Rear Tack

48" Tall Ramp Behind Rear Doors

Removable Lower Divider Panel

6' Aerodynamic Hayrack with Ladder and Tie Rails

Vented Generator Box for Hayrack

Aluminum Wheels

Neutral Stripe Package

THE MUSTANG

STRUCTURE AND CONSTRUCTION

Structure is the most important factor in building a trailer. Structure determines the longevity, durability and usability of the trailer. To keep components working at a high level, the trailer foundation needs to be strong. To construct this foundation, we use a welded structure throughout the frame. In addition to the welding, we utilize stainless huck fasteners and solid core rivets where necessary.

Top Rail – Continuous 5" radius rail with an overall height of 8" and a material thickness of 3/16" with an integrated drip rail.

Drop Gusset – 3/16" thickness, welded one piece gussets which add structure to provide maximum nose strength.

adds structure to provide maximum nose strength.

Drop Wall – 3/16” thickness with engineered break on top and bottom that adds strength and allows for a cleaner weld area to ensure against leakage.

Flooring – The Mustang’s floor structure consists of 4” I-beams with an upper 2-1/2” flange and a lower 3” flange on 12” centers. Elite utilizes a .125” thick, 5052 marine grade sheet floor on top of the structure.

Rear Frame – The rear frame is supported by a 2-1/2” x 5” upper header up to a 1/4” thick. For added strength, the rear frame side post is integrated through the floor into the bottom rail.

Aluminum Side Wall Construction – 6005 T6 aluminum alloy posts with 7” posts at the drop wall, 5” x 1-3/8” at doors and dividers, and 1-3/8” x 2-1/2” for all other side wall structure posts. The exterior, 6063 aluminum interlocking extruded slat is .125” thick. Exterior smooth sheets are a 3004 aluminum alloy with H291 temper and a thickness of up to .050”.

Roof Construction – 1” x 2-1/2” arched roof bows with one piece, .040” thick 3003 H16 aluminum roof sheet.



MUSTANG COMPONENTS

The components of a trailer determine ease of use, safety, and reliability of your trailer. Elite builds or purchases the best components available to the industry.

Doors – All Elite doors are built with heavy duty, proprietary extrusions and constructed to allow for maximum seal.

Drop Bars – The New Mustang Drop Bars are built to be long lasting and designed for simple use.

Lighting – Elite utilizes LED interior dome lights and exterior clearance lighting in all products standard.

Wiring Harness – Elite uses an automotive type encased wiring harness. All wiring connections are plugs or are soldered and covered with heat shrink material.

Horse Dividers – The Elite Mustang divider is built with designed extrusions that give it maximum strength.

Lining and Insulation – With 4 tiers of protection, the Mustang sidewalls provide protection from horses kicking and pawing, and helps prevent damage and exterior dings.

Wall Rubber – The wall rubber on the Mustang and Mustang LQ is corded smooth rubber matting that is able to absorb impacts that would damage lesser made products.

Axles and Tires – Elite uses Dexter Rubber Torsion axles with electric brakes and name brand tires based on the history of reliability.

Hinges – Elite's proprietary, heavy duty, extruded hinge is used for doors and dividers. This hinge is fitted with a brass fitting that lubricates and allows for a tighter fit the stainless pin. The hinge is welded to the structure to give us the strongest hinge possible.

Windows – Elite only uses the best of purchased windows. Available in many sizes and types, you can rest assured that they will be stalled, worry free.

Saddle Racks – The Elite built saddle racks are designed to hold a large variety of today's saddles.

Carpet – To provide longer durability, marine grade carpeting is used on all saddle racks and the dressing room of the Mustang.

THE ELITE FIT AND FINISH

Elite Trailers goes beyond our competition with fit and finish. The welds throughout the trailer are unmatched. Components are sanded or tumbled to provide a smooth touch without edges that can injure your horses. In areas where caulk is used, it is applied to coordinate the product and is done with great care not to take away from the trailer appearance. All trailers are checked against leaking.

MUSTANG LQ

8'8" LIVING QUARTERS

8'8" LIVING QUARTERS SPECIFICATIONS INCLUDE:

Sofa Sleeper or Dinette

16,000 BTU Ducted Furnace

Dual 20# LPG Tanks with Regulator

3 Cubic Foot Refrigerator

Large Radius Shower

Separate Toilet

Bathroom Sink

Large Wardrobe Closet

Two-Burner Cooktop

Microwave

Kitchen Sink

AM/FM Stereo with CD Player

TV Antenna Package

Queen Size Mattress

13,500 BTU Air Conditioner with Heat Strip

Interior Company, Specifications & Options may vary based on Dealership



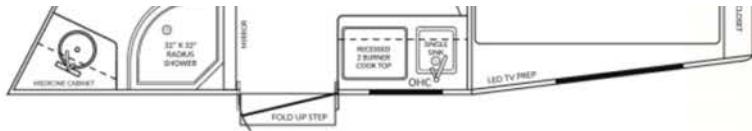

8'8" LIVING QUARTERS - FLOOR PLAN



MUSTANG LQ

10'8" LIVING QUARTERS

4 Floor Plan Layout Options Available

10'8" LIVING QUARTERS SPECIFICATIONS INCLUDE:

Sofa Sleeper or Dinette

16,000 BTU Ducted Furnace

Dual 20# LPG Tanks with Regulator

6 Cubic Foot Refrigerator

Large Radius Shower

Separate Toilet

Bathroom Sink

Large Wardrobe Closet

Two-Burner Cooktop (Based on Layout)

Microwave

Kitchen Sink

AM/FM Stereo with CD Player

TV Antenna Package

Queen Size Mattress

13,500 BTU Air Conditioner with Heat Strip

Interior Company, Specifications & Options may vary based on Dealership





10'8" LIVING QUARTERS - FLOOR PLAN 1

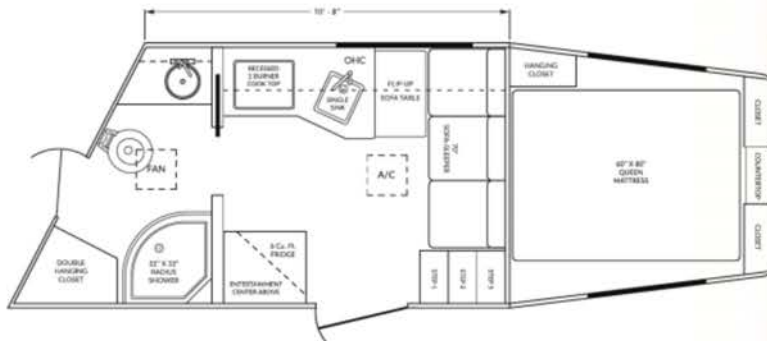

10'8" LIVING QUARTERS - FLOOR PLAN 2



10'8" LIVING QUARTERS - FLOOR PLAN 3

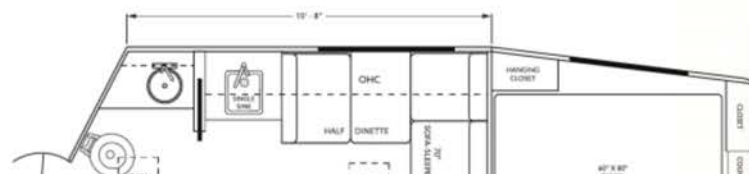

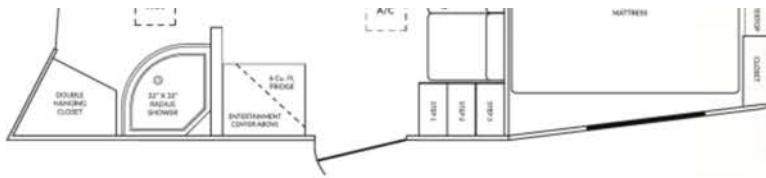

10'8" LIVING QUARTERS - FLOOR PLAN 4











ELITE TRAILERS

GET MORE INFO AND VIEW OUR GALLERIES ONLINE

<http://elitetrailers.com>





In 1995, Elite Trailers was formed with the passion and dedication to producing the highest quality aluminum trailer available to the market. With a fully supported staff of experienced and skilled employees, Elite Trailers has built on this passion, placing the customer and trailer first and foremost.

Elite's state of the art manufacturing facility with almost 250,000 square feet of manufacturing and service under roof was designed & built with one goal: The efficient manufacturing of the world's finest aluminum trailer. Elite has also made substantial investments in computerized tooling that is second to none in the industry. Designed to not only improve the fit, finish and structural integrity of our finished trailer, it has provided manufacturing process improvements that allow us to spend more time on the details that are important to you.

We use the best materials & construction practices to construct a superior built trailer. We build each trailer with acute attention to detail and finish it with the luxury that exceeds your standards. We construct our trailers to the highest of industry standards and pride ourselves on the creation of a lasting product. Our dealer network is experienced at helping design the trailer around your needs. Elite supports their dealer network with knowledgeable and experienced sales, parts and warranty, engineering and purchasing departments. Our customers need and expect the best! We're proud to build custom trailers that are as solid as the folks who buy them.

Elite Trailer is designed and engineered to haul your livestock comfortably and safely for distances far and wide. It will work as hard as you, it will be dependable, and it will stand the test of time. Custom trailers with impeccable quality and durability are our product; exceeding the expectations of our customers is our business.

AUTHORIZED ELITE TRAILER DEALER



7700 SW 29TH ST. OKLAHOMA CITY, OK 73179
VIEW MORE ONLINE <http://elitetrailers.com>